

Prairie Church 1/87 scale

C.T.'s Old West Series

001



This model kit contains everything you need to make a scale paper model of a simple church, common to the prairie towns of the Old West. This model was inspired by the little church at the end of main street at South Dakota's Own 1880 town, a small collection of original buildings and train cars from around the Dakota Territory.

1880 Town is located between Kadoka and Murdo on Interstate 80, in south western South Dakota.

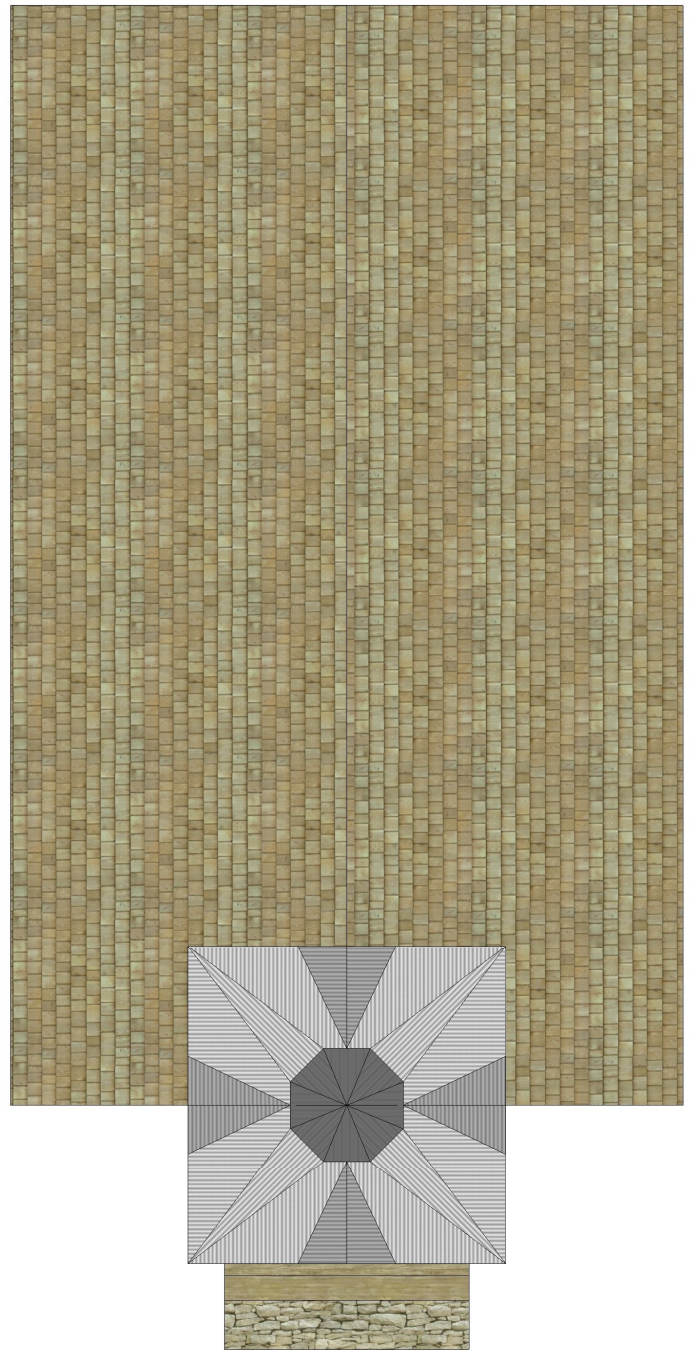
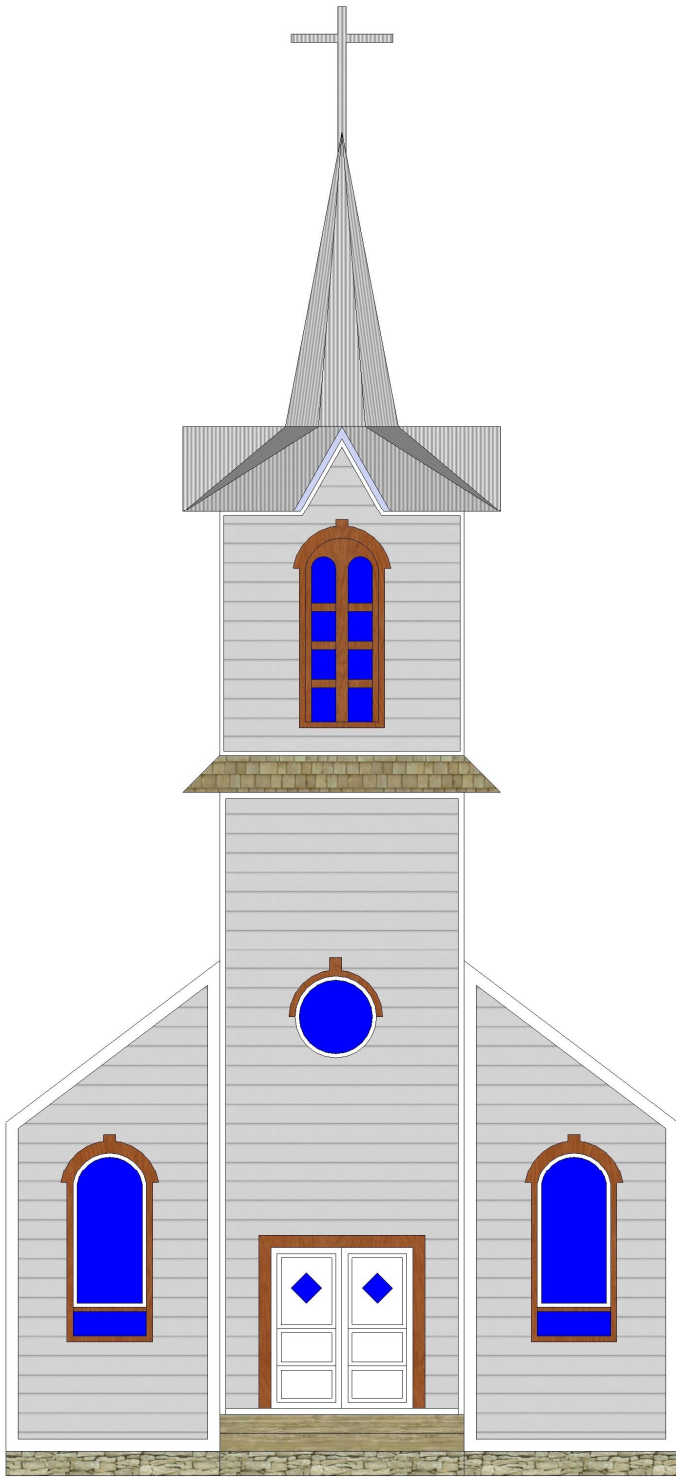

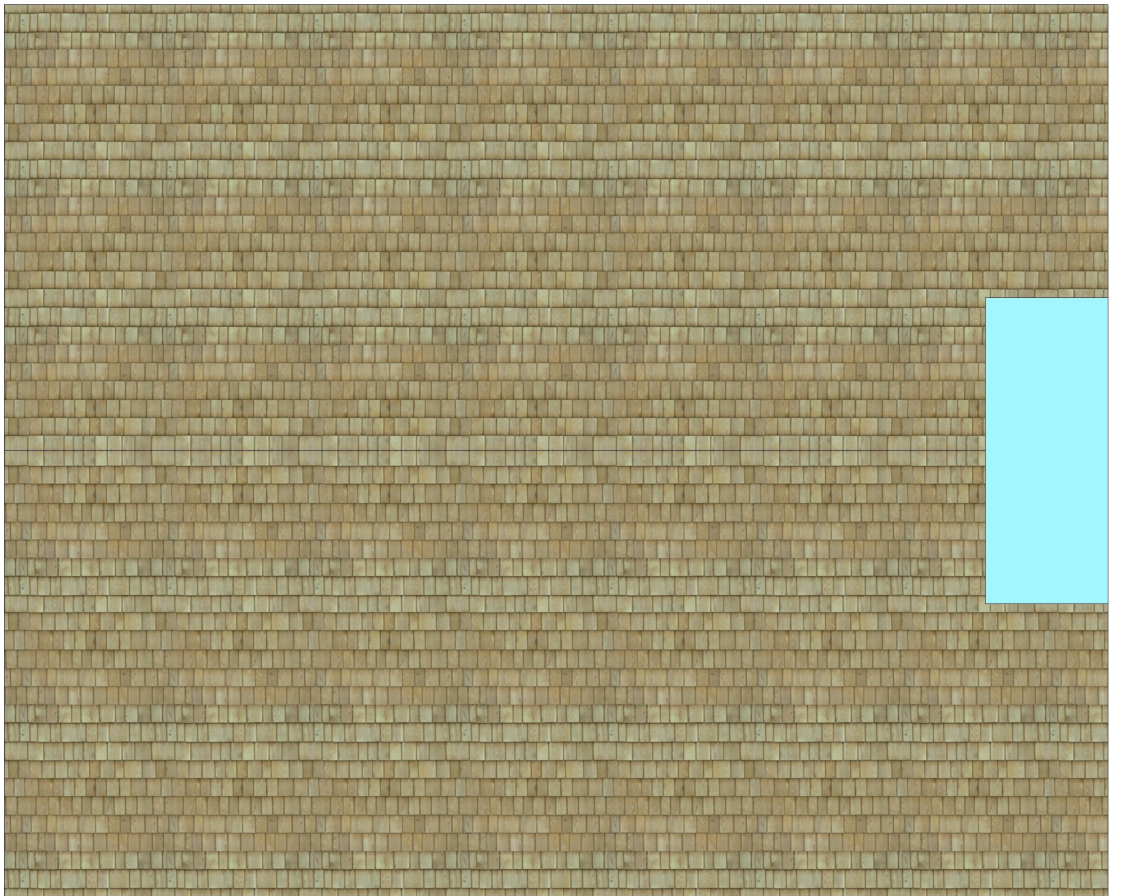
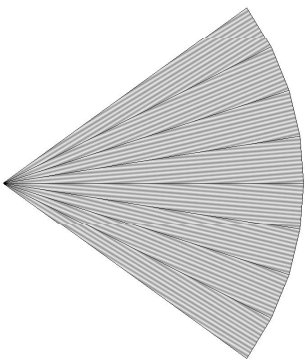
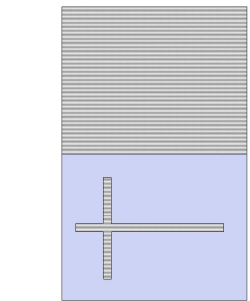
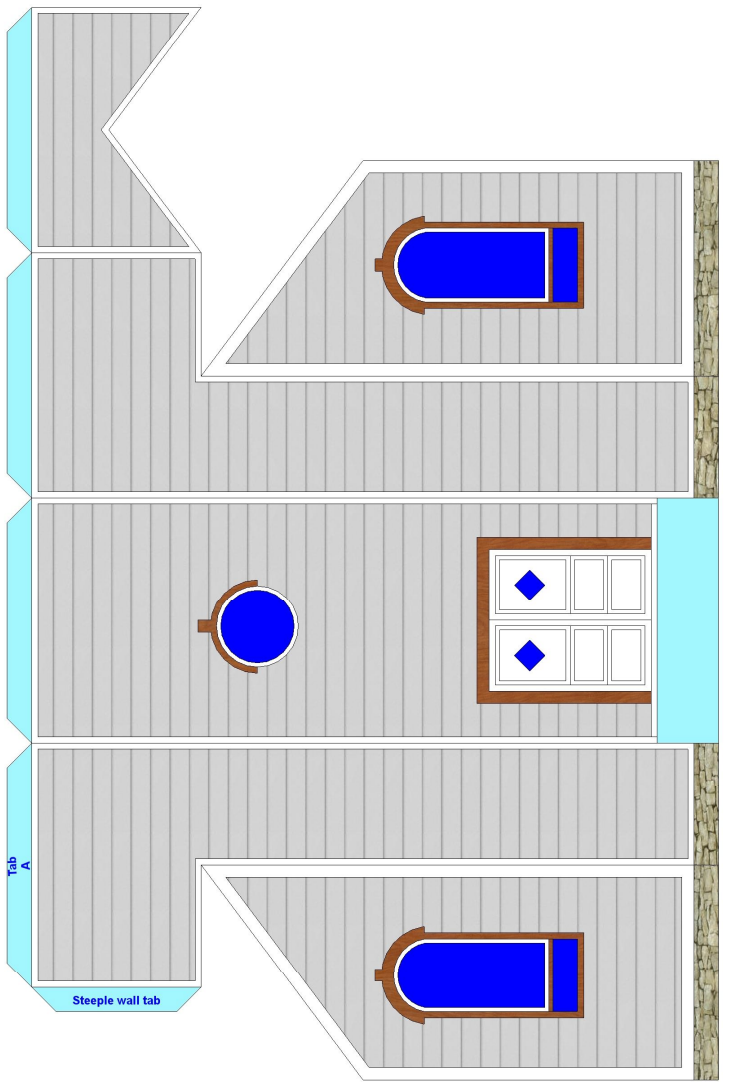
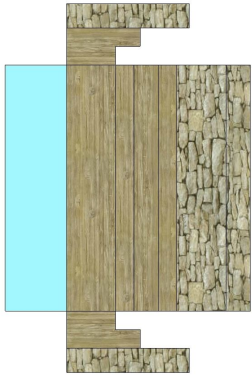
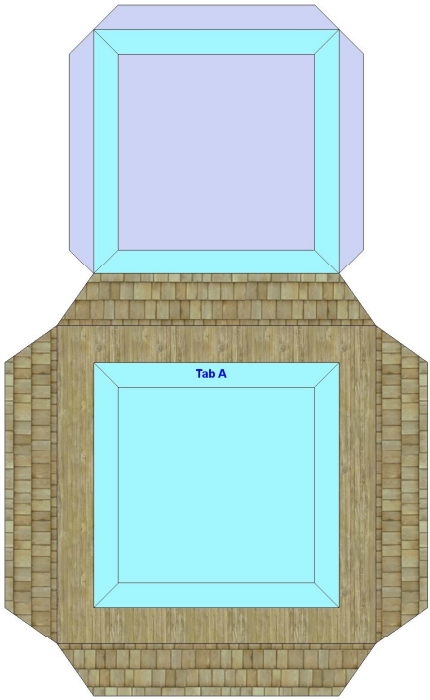

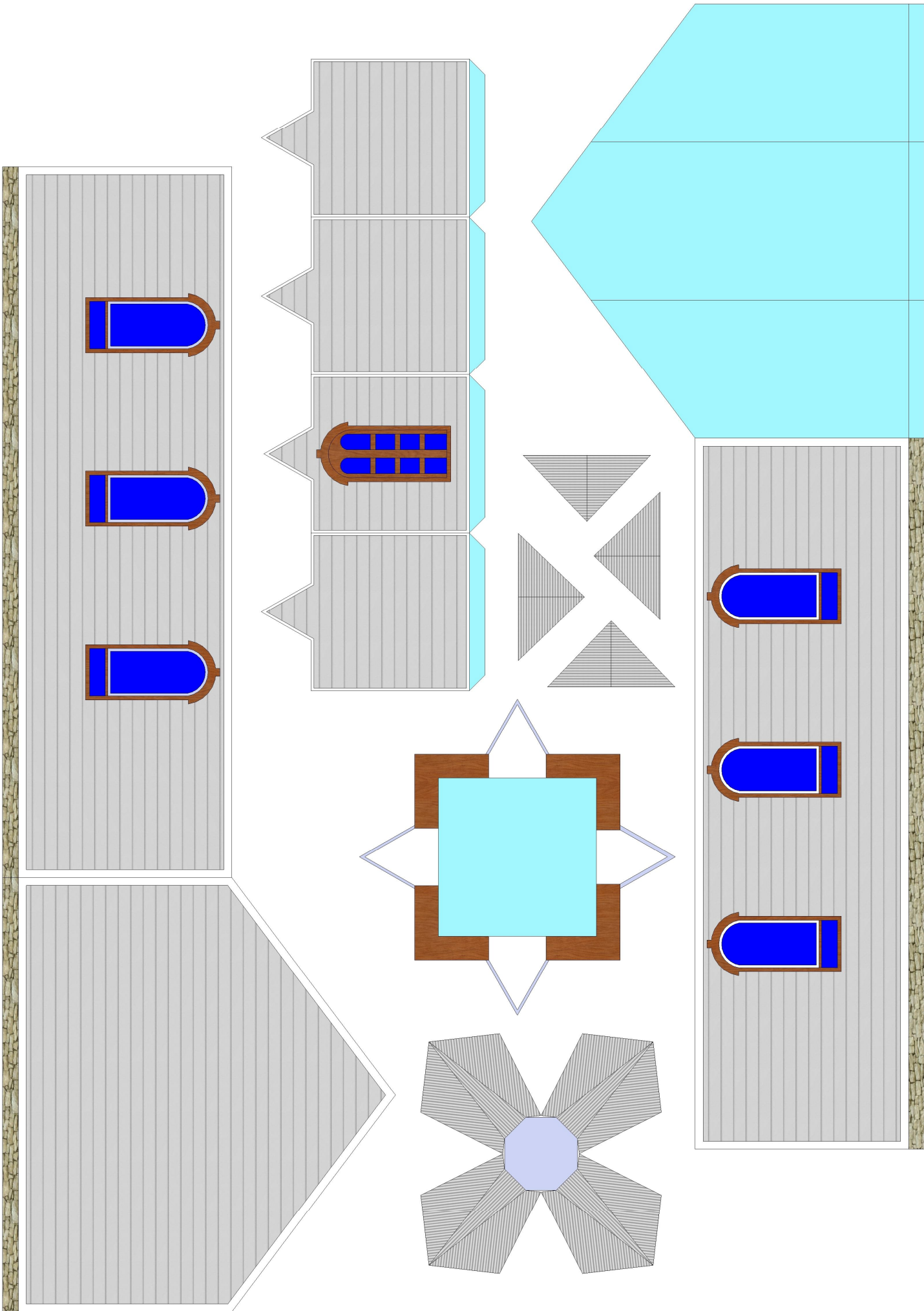

The model bas may be glud to 1mm card or to foamboard.

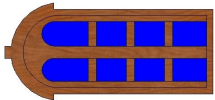
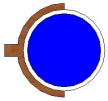

These window pices may be cut out and glud to the model to make a 3-D look.

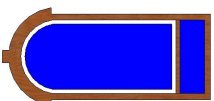
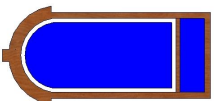
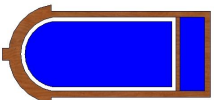
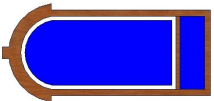
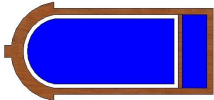
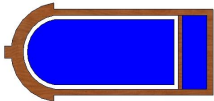

optional lamp post.
Make a two four sided tubes and slide the longer thinner post into the short outer base. The fold and glue the yellow "glass" pieces into the lamp and glue it to the top of the post.

